



TRANSFER OIL

Pure Fluid Attitude



Female NPT | Torpedo MP

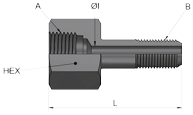

| Part no. | Description | Side A | Side B | ID | HEX | L | MAWP |
|-----------------------|-------------------------------|--------|--------|-----|-------------|----|------|
| D9DFC 02MS04 01 | 1/8 F-NPT M-MP* 1/4 15k 316D | 1/8 | 1/4 | 2.8 | 5/8 16 | 43 | 15k |
| D9DFC 02MS06 01 | 1/8 F-NPT M-MP* 3/8 15k 316D | 1/8 | 3/8 | 5.2 | 5/8 16 | 49 | 15k |
| D9DFC 02MS09 01 | 1/8 F-NPT M-MP* 9/16 15k 316D | 1/8 | 9/16 | 6 | 3/4 19 | 55 | 15k |
| D9DFC 02MS12 01 | 1/8 F-NPT M-MP* 3/4 15k 316D | 1/8 | 3/4 | 6 | 7/8 22 | 63 | 15k |
| D9DFC 02MS16 01 | 1/8 F-NPT M-MP* 1 15k 316D | 1/8 | 1.00 | 6 | 1+3/16 30 | 80 | 15k |
| D9DFC 04MS0 401 | 1/4 F-NPT M-MP* 1/4 15k 316D | 1/4 | 1/4 | 2.8 | 3/4 19 | 46 | 15k |
| D9DFC 04MS06 01 | 1/4 F-NPT M-MP* 3/8 15k 316D | 1/4 | 3/8 | 5.2 | 3/4 19 | 52 | 15k |
| D9DFC 04MS09 01 | 1/4 F-NPT M-MP* 9/16 15k 316D | 1/4 | 9/16 | 8 | 3/4 19 | 58 | 15k |
| D9DFC 04MS12 01 | 1/4 F-NPT M-MP* 3/4 15k 316D | 1/4 | 3/4 | 8 | 7/8 22 | 66 | 15k |
| D9DFC 04MS16 01 | 1/4 F-NPT M-MP* 1 15k 316D | 1/4 | 1.00 | 8 | 1+3/16 30 | 82 | 15k |
| D9DFC 06MS04 01 | 3/8 F-NPT M-MP* 1/4 15k 316D | 3/8 | 1/4 | 2.8 | 1 26 | 49 | 15k |
| D9DFC 06MS06 01 | 3/8 F-NPT M-MP* 3/8 15k 316D | 3/8 | 3/8 | 5.2 | 1 26 | 55 | 15k |
| D9DFC 06MS09 01 | 3/8 F-NPT M-MP* 9/16 15k 316D | 3/8 | 9/16 | 8 | 1 26 | 61 | 15k |
| D9DFC 06MS12 01 | 3/8 F-NPT M-MP* 3/4 15k 316D | 3/8 | 3/4 | 11 | 1 26 | 69 | 15k |
| D9DFC 06MS16 01 | 3/8 F-NPT M-MP* 1 15k 316D | 3/8 | 1.00 | 12 | 1+3/16 30 | 85 | 15k |
| D9DFC 08MS0 401 | 1/2 F-NPT M-MP* 1/4 15k 316D | 1/2 | 1/4 | 2.8 | 1+3/16 30 | 54 | 15k |
| D9DFC 08MS06 01 | 1/2 F-NPT M-MP* 3/8 15k 316D | 1/2 | 3/8 | 5.2 | 1+3/16 30 | 60 | 15k |
| D9DFC 08MS09 01 | 1/2 F-NPT M-MP* 9/16 15k 316D | 1/2 | 9/16 | 8 | 1+3/16 30 | 66 | 15k |
| D9DFC 08MS12 01 | 1/2 F-NPT M-MP* 3/4 15k 316D | 1/2 | 3/4 | 11 | 1+3/16 30 | 74 | 15k |
| D9DFC 08MS16 01 | 1/2 F-NPT M-MP* 1 15k 316D | 1/2 | 1.00 | 14 | 1+3/16 30 | 90 | 15k |
| D9CFC1 2MS040 1 | 3/4 F-NPT M-MP* 1/4 10k 316D | 3/4 | 1/4 | 2.8 | 1+3/8 35 | 54 | 10k |
| D9CFC1 2MS060 1 | 3/4 F-NPT M-MP* 3/8 10k 316D | 3/4 | 3/8 | 5.2 | 1+3/8 35 | 60 | 10k |
| D9CFC1 2MS090 1 | 3/4 F-NPT M-MP* 9/16 10k 316D | 3/4 | 9/16 | 8 | 1+3/8 35 | 66 | 10k |
| D9CFC1 2MS1201 | 3/4 F-NPT M-MP* 3/4 10k 316D | 3/4 | 3/4 | 11 | 1+3/8 35 | 74 | 10k |
| D9CFC1 2MS1601 | 3/4 F-NPT M-MP* 1 10k 316D | 3/4 | 1.00 | 14 | 1+3/8 35 | 90 | 10k |
| D9CFC1 6MS060 1 | 1 F-NPT M-MP* 3/8 10k 316D | 1.00 | 3/8 | 5.2 | 1+3/4 45 | 66 | 10k |

| | | | | | | | |
|-----------------------|-----------------------------|------|------|----|------------|----|-----|
| D9CFC1 6MS090 1 | 1 F-NPT M-MP* 9/16 10k 316D | 1.00 | 9/16 | 8 | 1+3/4 45 | 72 | 10k |
| D9CFC1 6MS1201 | 1 F-NPT M-MP* 3/4 10k 316D | 1.00 | 3/4 | 11 | 1+3/4 45 | 80 | 10k |
| D9CFC1 6MS1601 | 1 F-NPT M-MP* 1 10k 316D | 1.00 | 1.00 | 14 | 1+3/4 45 | 96 | 10k |

*I valori e le dimensioni mostrate possono essere modificati senza preavviso per migliorare le prestazioni e l'affidabilità del prodotto.
Transfer Oil S.p.A. non si assume alcuna responsabilità per imprecisioni o errori che appaiono in questa scheda tecnica.*

Data documento: 28/04/2026

www.transferoil.com